

Flemings



208 Hovell Street Cootamundra NSW

4 2 3

208 Hovell Street, Cootamundra provides purchasers with an excellent opportunity to secure a spacious family home set on a large block at an affordable price.

The property consists of 4 bedrooms with ensuite to the main bedroom, bathroom, a large family room opening onto the adjacent dining area, kitchen, laundry, evaporative cooling, wood fire heating & reverse cycle air-conditioning. Outside boasts an outdoor entertaining area, single carport, double bay garage, garden shed and separate fenced yard at rear with separate access, all set on a large 1,016sqm block.

Features include:

- 4 beds, 2 bath
- Single Carport
- Double bay shed

Land Size : 1016 sqm

View : <https://www.flemingspropertyservices.com/sale/nsw/riverina/cootamundra/residential/house/6531774>



Chris Ryan
02 6942 2480

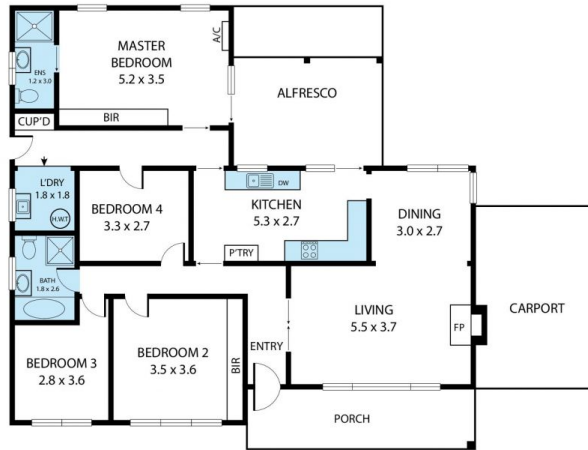
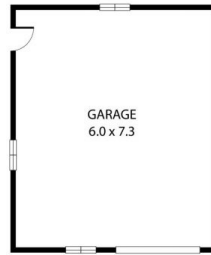

208 Hovell Street, Cootamundra 2590

TOTAL APPROX. FLOOR AREA 131 SQ.M

Whilst every attempt has been made to ensure the accuracy of the floor plan contained here, measurements of doors, windows, rooms and any other items are approximate and no responsibility is taken for any error, omission, or misstatement. This plan is for illustrative purposes only and should be used as such by any prospective purchaser.

Flemings